

Great Swan Port August 1831

Memorandum  
for the  
Hon. the  
Governor

Sr.

I have the honor to make Application to locate the additional Grant of 750 Acres of Land ordered me by His Excellency the Lieutenant Governor on the unlocated Land between my present grant and that of Mr Webber and at the back of my present grant in the following manner -

To take in the whole of <sup>the</sup> unlocated Land between my side Line and that of Mr Webber and to continue past the corner post of Mr Webber to the foot of the Tier, thence running about N. 45° E. to my present corner tree at the Rocky Hills. Referable to the enclosed plan -

(A plan accompanied this statement shows that the Land applied for contained as near as possible the quantity of Land ordered the ~~Lieutenant~~ General having promised me that if it should rather exceed that quantity he should allow me to take it in consideration of the barrenness of the ground & the quantity of Tier included - The following is nearly exact  
Sent the Plan

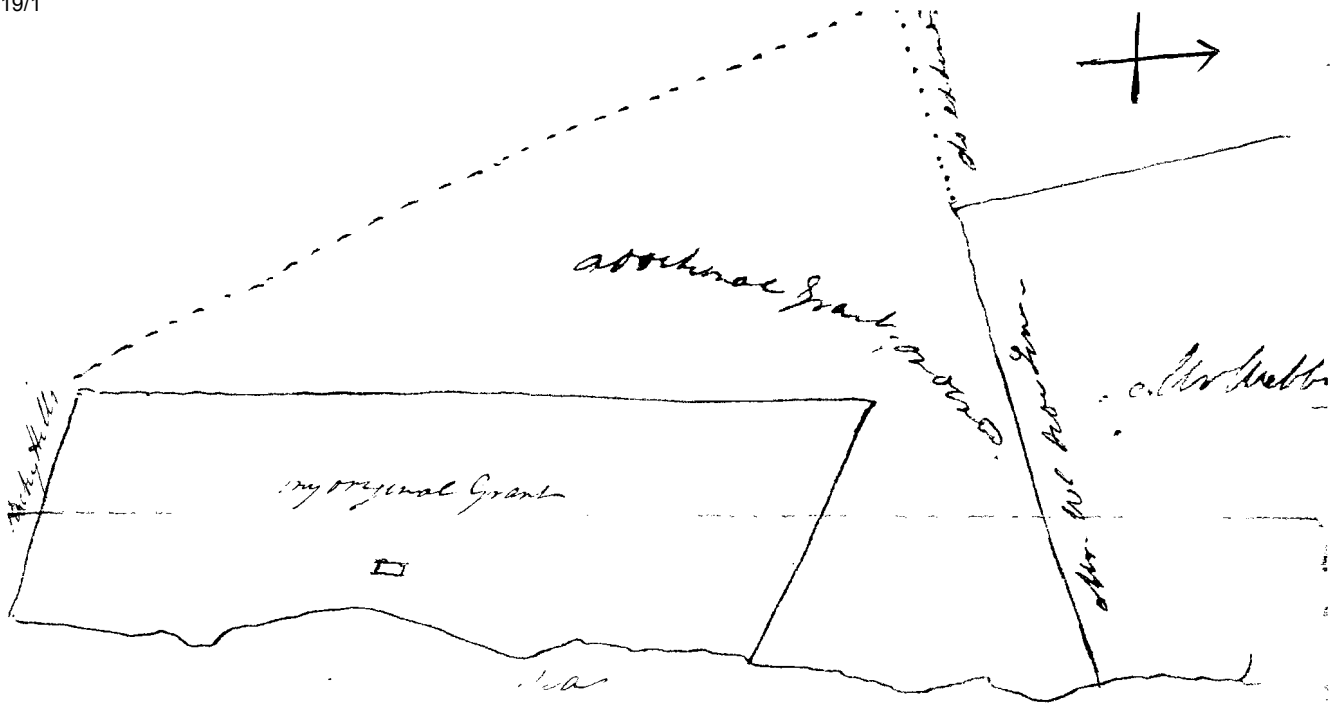

Mr. Webster upon the Authority he holds from you  
 knowing that my <sup>original</sup> ~~front~~ back line did not come when he  
 has stripped. thought he might perhaps try to obtain the  
 back he has stripped - but I told him plainly &  
 distinctly in the presence of - ~~Dumbar~~ that ~~my~~  
~~land~~ extended beyond the end of his side line to  
 the foot of the river a distance of nearly half a  
 mile of not more beyond his corner tree & running ~~and~~  
~~rely~~ 2 ~~steps~~ points to S.

Mr. Webster's grant is about 250 rods long  
 & 100 rods wide  
 & contains 25000 acres  
 & is situated on the  
 N.W. corner of the  
 original grant

I am now just proceeding to the place I pointed  
 out to you yesterday for the purpose of removing  
 the marks - and if Mr. Webster persists in going on  
 as he has done I shall feel it my duty to  
~~bring against him to the utmost stretch of the Law~~